

HOW TO PLACE YOUR WOODY ON A WALL

In the package

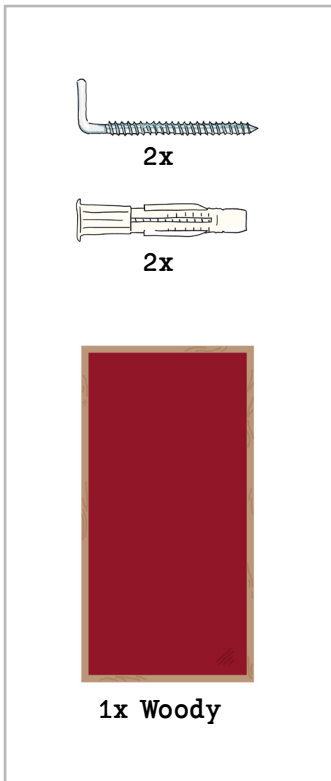

What else will u need?

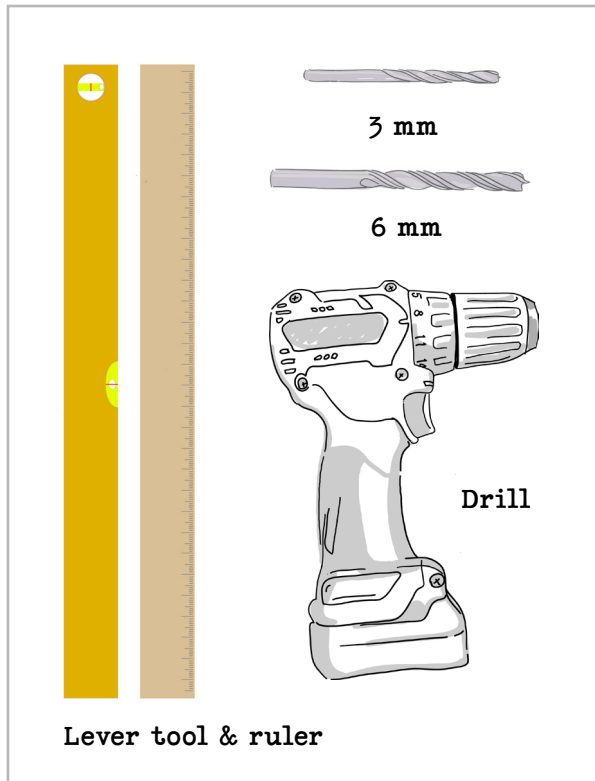

Tips & tricks



Keep in mind!

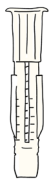

The plugs inside the package fit only into **masonry** and **concrete** walls.



If you have a **wooden** wall, you won't need a plug at all ...

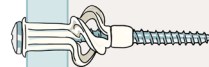

... but into **plasterboard** wall or **hollow bricks**, you'll need to buy another special plug - which is **not included**.

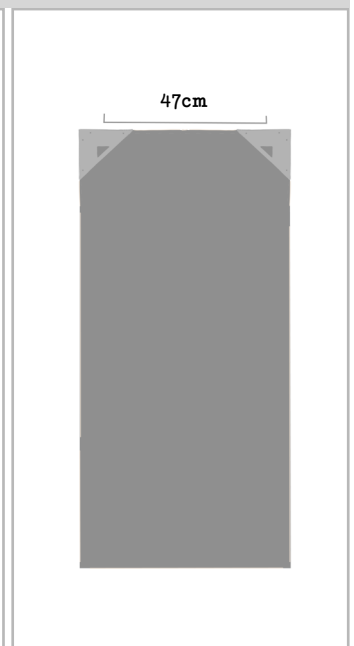
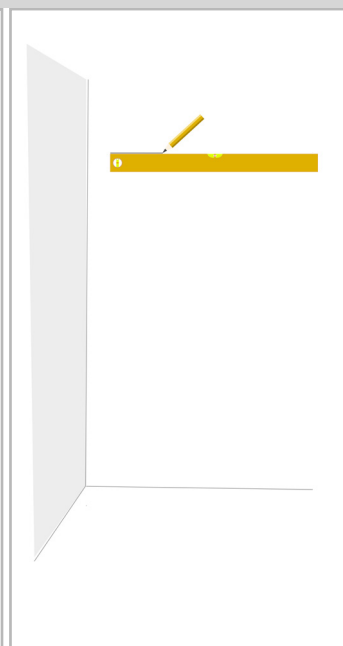
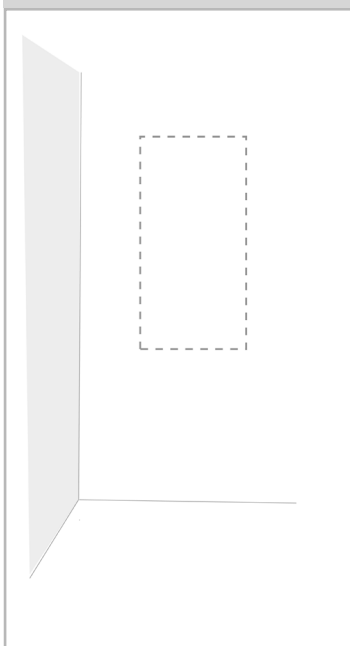

1. Choose the best place for your Woody. If unsure check out our **Tips & tricks** articles.

2. Use a lever tool to draw a **horizontal line** in the height where you wish to place your Woody.

3. Mark the spots where you'll need to drill holes for the plugs and hooks in the wall.

4. Make sure the distance between the **marked spots** = the distance between the holes in the **hanging system** on the back side of your Woody = **cca. 47 cm**.

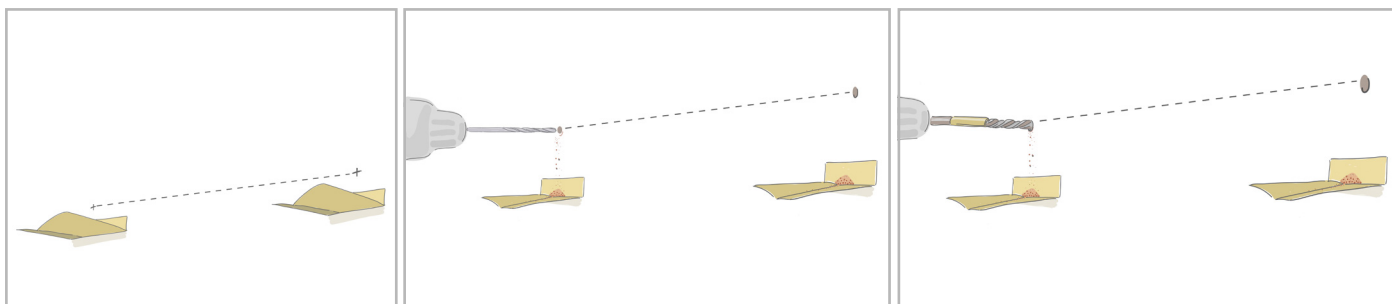

5. To **eliminate mess** from the crumbling wall while drilling, place **sticky notes** sheets **under the marked spots**.

6. Use the **smaller drill first** (3 mm) to avoid bigger damage on plaster and masonry.

7. Repeat drilling with the **6 mm drill size** = the **same size as your plugs**.

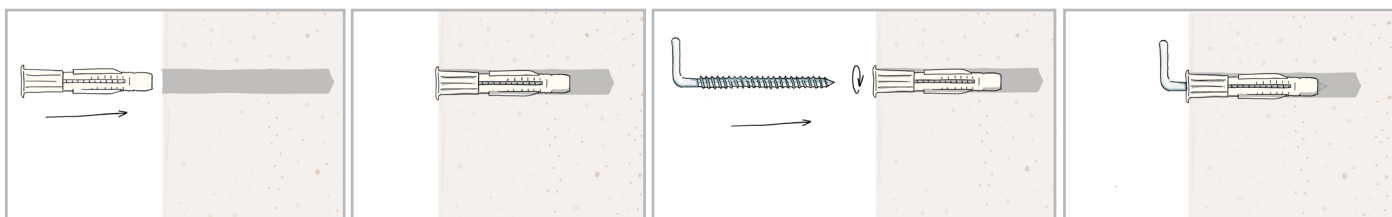

8. Insert the plug into each drilled hole.

9. Make sure it fits properly.

10. Screw hooks inside both plugs.

11. Now it should hold tight.

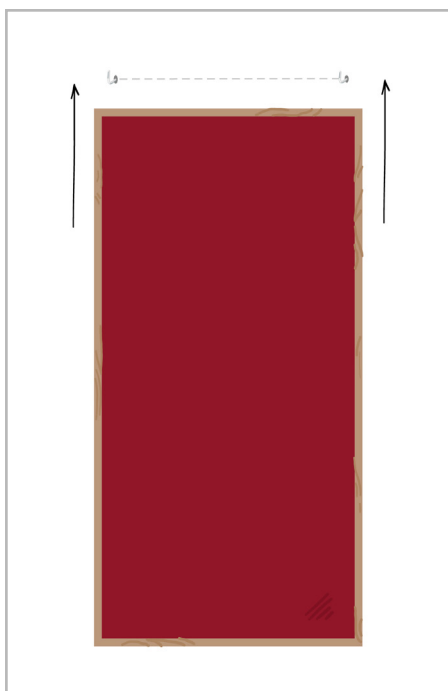

12. Place your Woody onto the hooks. If there's a **friend** around, ask them to help you.

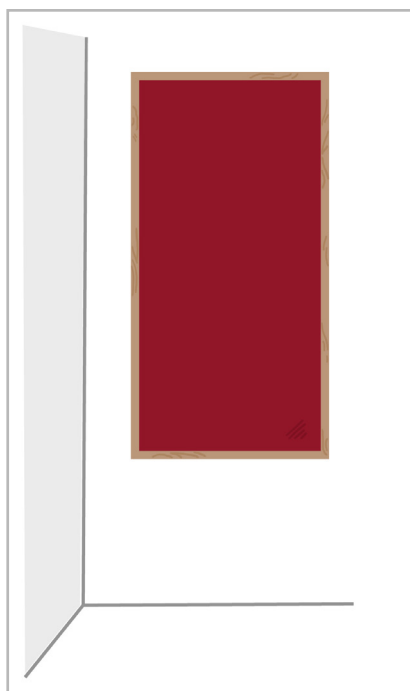

13. Admire your work.



13. Let's clean it all up for a bit...
... and you're ready Freddie

**THE END
CONGRATS!
NICELY DONE!**

Was this helpful? Do you have any question? Don't hesitate to **contact us!**



Different wall materials require different types of fixing devices. If you are uncertain about what type of screws and plugs to use, please contact your local hardware store.

